



upwardor

Garage Doors Designed for Life

RESIDENTIAL BROCHURE

FALL 2023

Table Of Contents

4 THE KANATA COLLECTION™

6 THE CRAFT SERIES™

8 **AL-976™**
Aluminum Doors

9 THERMALEX®

10 LIFTMASTER & GARAGE ORGANIZATION

11 MEASUREMENTS & SPECIFICATIONS



Trust Upwardor Quality Craftsmanship

For over **50** years, thousands of homeowners every year choose Upwardor. We are a leader in manufacturing quality doors that last! Our Dealers are selectively chosen because of their attention to detail and customer service.

**Call 1-800-667-3367 to find out more
or visit upwardor.com**

**Telephone: 905-876-3667
Fax: 905-876-3533
Email: sales@upwardor.com**

Shown:

Bronte Creek Steel Grey

**Quality Crafted,
Uniquely Styled.**

Since 1974

Residential Line



upwardor

Garage Doors Designed for Life

Shown:
Sheridan XL White

The Kanata Collection™

Combines style, durability and environmental friendliness. Polyurethane insulation is foamed in place, which ensures a consistent density and significant panel strength. With a 1^{3/4}" (44.5mm) thickness, R-value of 16.3, enhanced tongue and groove joint and a true thermal break, the Kanata Collection is an excellent choice for those who are looking for a high-quality, energy efficient residential garage door.



Customize Your Look!
Choose your own custom colours to match your home!

Colour Choices

- White
- New Almond
- Black
- Walnut
- Sandtone
- New Brown
- Bronze
- Steel Grey
- Hazelwood



Shown:
Flush Black



Shown:
Sheridan XL Bronze

The Kanata Collection™

Upwardor offers several design and decorative insert options, adding a custom touch to your garage door. Window inserts are interchangeable, providing a classic or decorative look to complement and add value to your home. Frames and inserts are carefully colour-matched and are UV protected.

Features and Options

- High-quality, versatile and eco-friendly
- With a built-in thermal break, this door is suitable for both cold and warm climates
- Multiple glazing window and insert options add value to any home
- Available in six designs: long and short raised panel, long and short carriage house, ribbed panel and flush versions

See Page 11 for Panel Choices and Window Designs

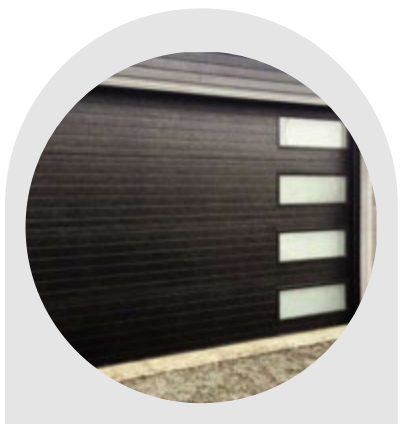

Shown:
Trafalgar Black



Shown:
Muskoka White

The Craft Series™

Represents the ultimate in style, durability and environmental friendliness. Our new three section taller panel design offers a truly distinct look while maintaining the quality and performance you would expect from a premium door, ideal for the homeowner who is looking for more than just curb appeal.



Customize Your Look!

Choose your own custom colours to match your home!

Colour Choices

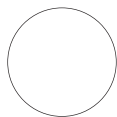

White



Sandtone



Walnut
(28" only)

Actual door colour will vary from colour renditions

Sizes

Available in two section heights



Shown:
Granville Walnut



Shown:
Denison White

The Craft Series™

Our premium residential offering, representing the ultimate in style, durability and environmental friendliness. The three-section, 1^{3/4}" (44.5mm) thick, taller panel design with an R-value of 16.3 appeals to the discerning homeowner who wants a distinct look without having to make compromises on the quality of their garage door.

Features and Options

- 26-gauge, pebble embossed exterior and interior steel back sheet
- Environmentally-friendly polyurethane insulation, 100% CFC free
- Built-in thermal break prevents cold/heat transfer from the exterior to the interior of the door

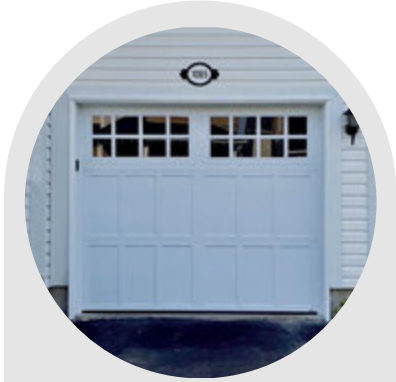

Shown:
Denison White

See Page 12 for Panel Choices
and Window Designs



Aluminum Doors
Shown: AL-976 Black with Acid Etched Glass

AL-976™

Our most popular Aluminum Door, manufactured since 1976, offers a variety of options where superior strength, maximum visibility and exceptional light transmission are required. Its unique and durable design allows customized configurations for openings up to 24' (7.32m) wide. This modern look can add class to any home.

Features and Options

- 1 3/4" (44.5mm) thickness
- Clear anodized finish standard
- Tongue and groove section with weather seal inhibits air infiltration
- Available with various glazing options: single, insulated, tinted, tempered or specialty



Customize Your Look!

Choose your own custom colours to match your home!

5 Year
Limited warranty on door finish

1 Year
Limited warranty workmanship and materials

See Page 13 for Panel Choices and Window Designs

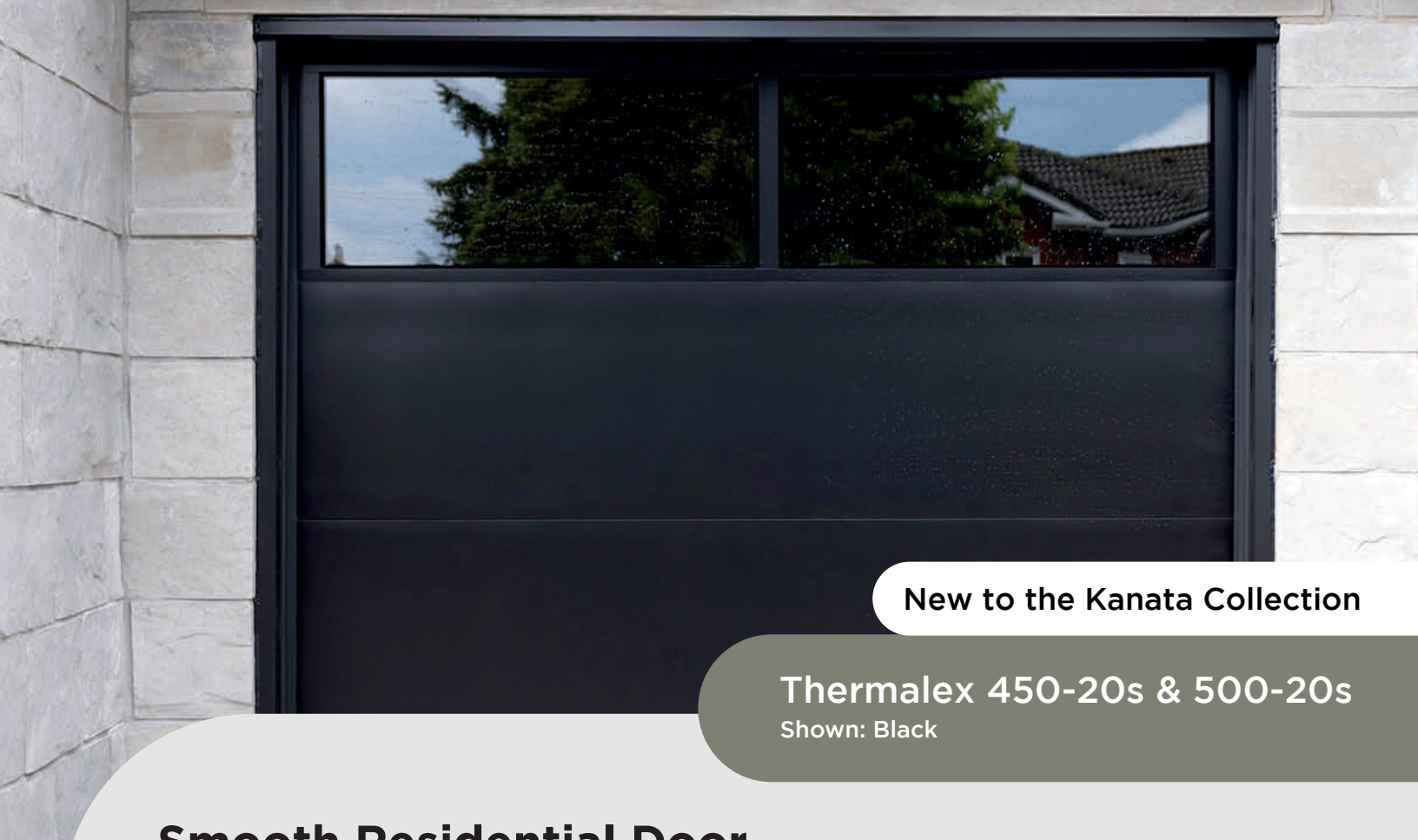

New to the Kanata Collection

Thermalex 450-20s & 500-20s
Shown: Black

Smooth Residential Door

Polyurethane insulation is foamed in place, which ensures a consistent density and significant panel strength. The TX450-20s has a 44.5mm (1³/₄") thickness, R-value of 16.3; and the TX500-20s has a 50.8mm (2") thickness, R-value of 18.4. Completely Smooth 20ga face and our new tongue and groove design with a true thermal break.



Shown:
Black TX450-20s

Key Benefits:

- High-quality, versatile and eco-friendly
- With a built-in thermal break, this door is suitable for both cold and warm climates
- Multiple glazing window and insert options add value to any home
- Available in Smooth Flush



Customize Your Look!

Choose your own custom colours to match your home!

Colour Choices

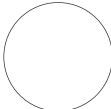

White



Black

LiftMaster

LiftMaster is the #1 brand of professionally-installed residential garage door systems and commercial door operators. From garages to gates, make your home's busiest entryways smarter, safer and more secure with LiftMaster's professionally installed home access solutions.



Garage Organization

A variety of garage organization offers solutions all made from high-grade steel. Our back plates have been engineered to disperse the workload throughout the wall so you can hang whatever you want, wherever you want. Available in colors: Graphite, Dove Grey, Sandstone, White, Black, and Blue.

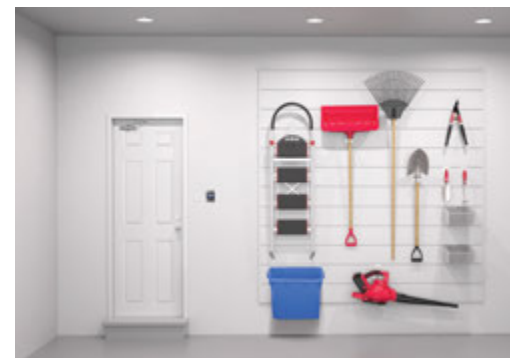
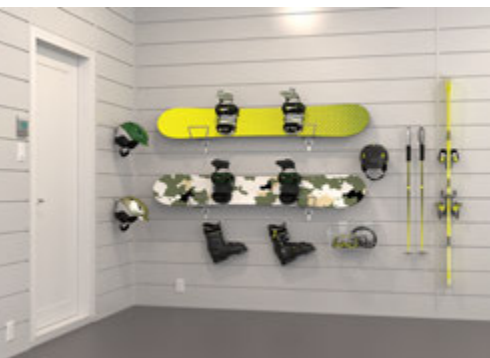

Measurements & Specifications

KANATA COLLECTION

Product Selection Guide & Specifications

EXTERIOR/INTERIOR STEEL BACKSHEET	26-GAUGE, PEBBLE EMBOSSED
HORIZONTAL REINFORCEMENT STRIP	25-GAUGE (2 PER PANEL)
END STILES – WHITE GALVANIZED	20-GAUGE
MAXIMUM STANDARD WIDTH	18'0" (5.49m)
MAXIMUM STANDARD HEIGHT	3" (76mm) INCREMENTS
SECTION HEIGHT	18", 21", & 24" (457, 533 & 610mm)
WARRANTY	LIMITED LIFETIME SEE WARRANTY SHEET
STANDARD RADIUS	15" (11" AVAILABLE UPON REQUEST)

Side View Illustration

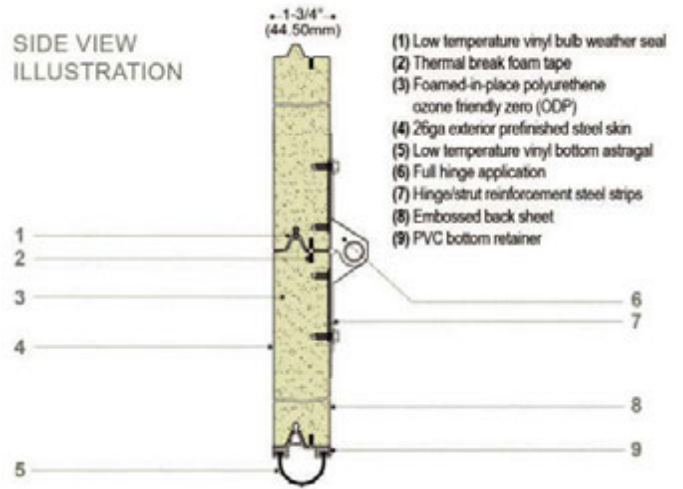

KANATA COLLECTION

Stamp Designs



Window Designs/Inserts

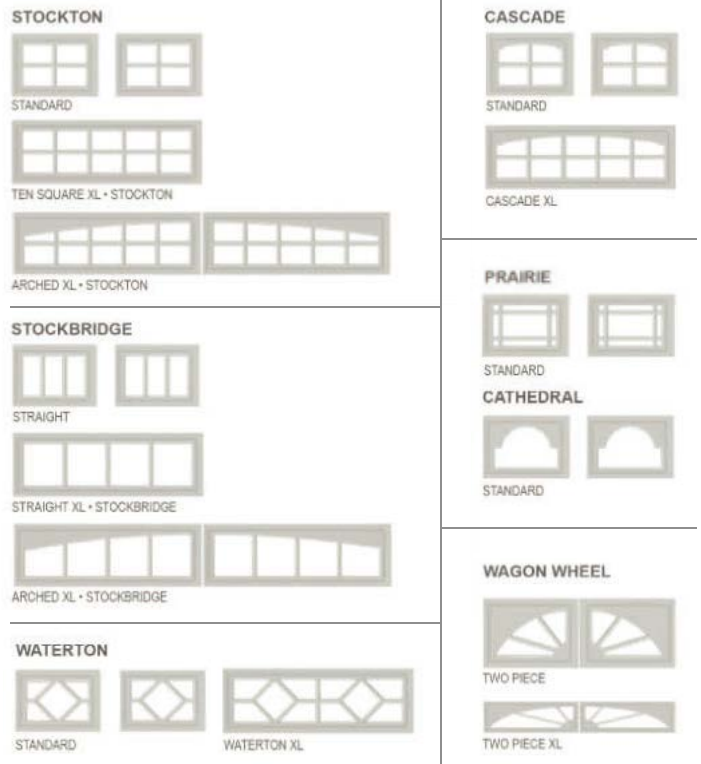

CRAFT SERIES

Product Selection Guide
& Specifications

THICKNESS/PRODUCT TYPE	1-3/4" (44.50mm)
EXTERIOR/INTERIOR STEEL BACKSHEET	26-GAUGE, PEBBLE EMBOSSED
INSULATION TYPE/FOAM PROCESS	ZERO ODP POLYURETHANE/CONTINUOUS
R-VALUE/U-VALUE	16.3/0.06
SECTION JOINT	TONGUE & GROOVE
HORIZONTAL REINFORCEMENT STRIP	25-GAUGE (2 PER PANEL)
END STILES – WHITE GALVANIZED	20-GAUGE
AVAILABLE WIDTHS	8', 9', 12', & 16'
MAXIMUM HEIGHT	8' & 7'
SECTION HEIGHT	28" & 32" (711 & 813mm)
WARRANTY	LIMITED LIFETIME SEE WARRANTY SHEET
HARDWARE WARRANTY	1-YEAR
STANDARD RADIUS	20"
CLEARANCE AT HEADER	23" MIN

Side View Illustration

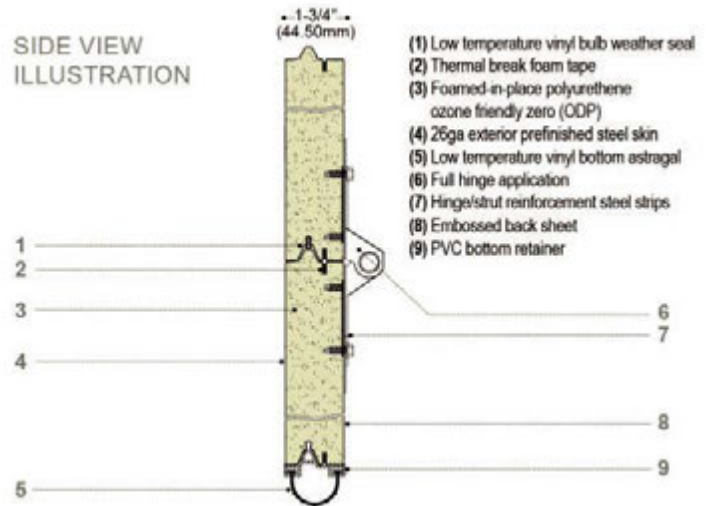

CRAFT SERIES

Panel Choices



Window Inserts

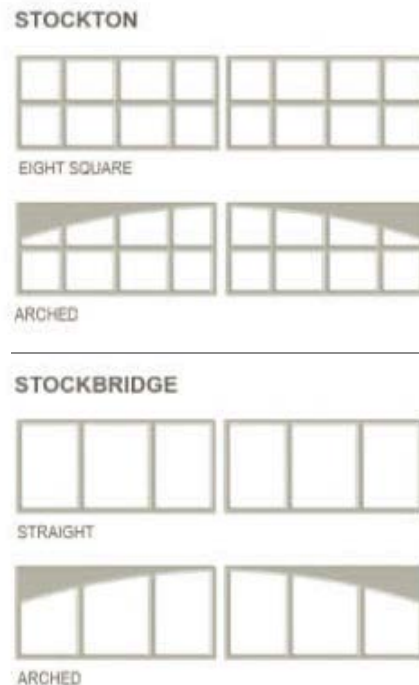

Visit upwardor.com
to explore Panel choices
and Window designs

ALUMINUM DOORS

Cross Section

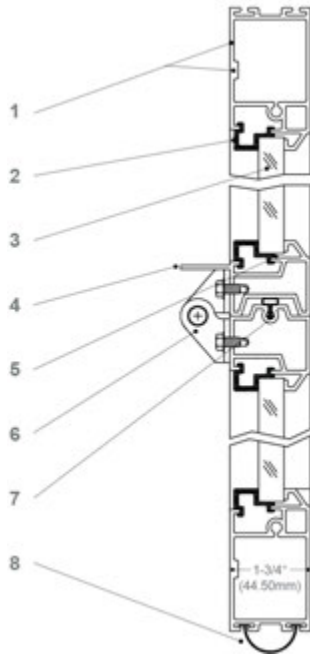

- (1) .070" (1.78mm) typical, .115" (2.92mm) at attachments
- (2) Glazing molding
- (3) Glazing
- (4) Reinforcing strut (optional under 16" [4.88m])
- (5) Soft vinyl glazing bead
- (6) Center hinge
- (7) Weather seal
- (8) Low temp. vinyl astragal

Visit **upwardor.com** to explore Panel choices and Window designs

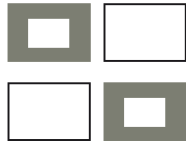

upwardor

Garage Doors Designed for Life

1-800-667-3367

T: 905-876-3667

F: 905-876-3533

sales@upwardor.com





For more product information visit:

[upwardor.com](https://www.upwardor.com)
